



# AN INTRODUCTION TO THE OPEN SCIENCE FRAMEWORK (OSF) FOR JHU RESEARCHERS

## What is the OSF?

- A **free** and **open source** web application built to aid researchers in managing the entire scientific research workflow.
- A **collaboration tool** and a **project management tool** that is also a registry and a repository.
- It is designed with a **flexible interface** that allows you to **manage multiple projects** from a single dashboard.

## Why use the OSF?

- **To simplify and integrate** your workflow into one space.
- **To manage collaborative research** with version control and access control.
- **To share and register work** with both public and private options.
- **To organize** your Laboratory work and administrative processes.

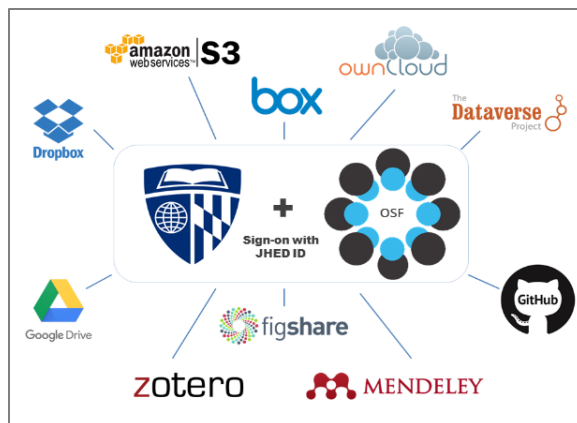

*Service add-ons bring together documents, data, code, and related products that are stored in different spaces.*

## What are the benefits of using OSF for JHU?

- Institutional affiliation facilitates **greater recognition** for you, your collaborators, and JHU.
- Foster **serendipitous connections** for further collaboration

Name	Contributors	Modified
JHU Lab Organization Template	Boehm, Chiu	3 days ago
US Cattle Traceability Information - State Go...	Boehm	3 days ago
Does Perceptual Consciousness Overflow Co...	Steven Gross, Flombaum	7 days ago
Preserving and Sharing Software for Transp...	Rios	15 days ago

*Via the institutional portal your JHU affiliated public projects are easily discovered by JHU researchers and other interested academic stakeholders.*

<https://osf.io/institutions/jhu>



# AN INTRODUCTION TO THE OPEN SCIENCE FRAMEWORK (OSF) FOR JHU RESEARCHERS

How Do I Log-in and Affiliate myself with JHU on the OSF?

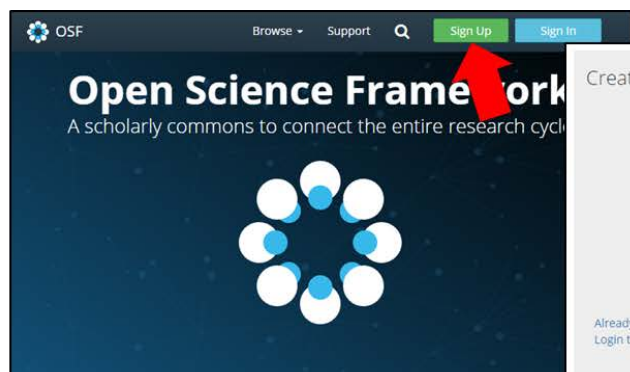

Navigate to <https://osf.io/> and click the Sign Up button.

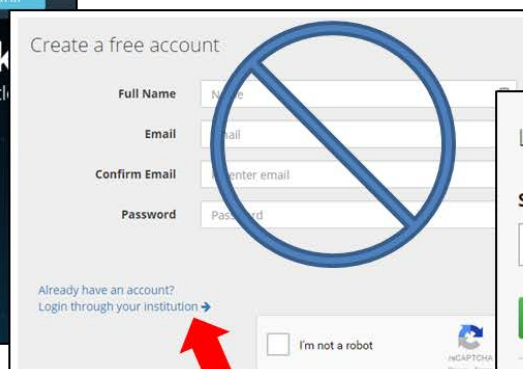

On the next page click the “[Login through your institution](#) →” Link

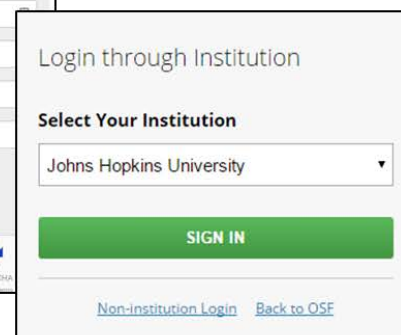

Select JHU and “Sign In” – then use your **JHED ID** and **Password** to do the rest!

## Links to More Information

- Open Science Framework: <https://osf.io/> (Sign up here)
- Center for Open Science: <https://cos.io/> (the organization behind the OSF)
- FAQs and Guides: <https://osf.io/support/>
- OSF support: [support@cos.io](mailto:support@cos.io)
- See our website for FAQs about the OSF for JHU: <http://dms.data.jhu.edu/data-management-resources/manage-and-analyze/collaboration-tools/open-science-framework-for-jhu/>
- Contact us for additional guidance: [datamanagement@jhu.edu](mailto:datamanagement@jhu.edu)



JOHNS HOPKINS  
LIBRARIES  
DATA MANAGEMENT SERVICES